



CHEMCREST INC.
chemcrest.com

COLUMN WRAPS, SHUTTERS, GABLES, LOUVRES, BRACKETS

For a Classic Finished Architectural Appearance;
Beautiful, Practical, Durable, virtually maintenance free!

Chemcrest is a leading manufacturer of innovative synthetic millwork for interior and exterior decorative architectural accents. Since 1984, builders, architects, designers, trim carpenters and aluminum siding firms have relied on Chemcrest products to deliver value to the customers they serve.

Manufactured by Chemcrest, Inc.
157 Rivermede Road
Concord, ON L4K 3M4
1-800-665-6653 Toll Free (US & Canada)
Fax 1-888-715-1813
www.chemcrest.com



CANADA 150
MADE IN CANADA



For further information
scan this QR code on your
smartphone or visit
chemcrest.com

PVC COLUMN WRAP INSTALLATION INSTRUCTIONS

Chemcrest Column Wraps Are Not Load Bearing.

They are designed to enhance the appearance of existing structural posts. Consult local building and safety codes for specific compliance requirements.

Column Wraps are shipped flat for easy transport and on-site assembly.

Kit Contains: 4 column panels, 4 cap & base panels and 2 squaring blocks.

Other Items You'll Need: 24 - 1½ "non-corrosive mechanical fasteners (38.1mm) (e.g. stainless steel screws), Cellular PVC Cement (clear or white) Carpenters Level, Measuring tape. Masking Tape Power Saw, Power Drill, 3/16" Drill Bit (4.76 mm), Disposable gloves, eye protection, two disposable 1" paint brushes (25.4mm), Acetone and clean rag.

Step By Step Installation Instructions:

1) Measure distance between floor and column (twice) note measurement and cut panel by ¼" less than measured distance (6.35mm).

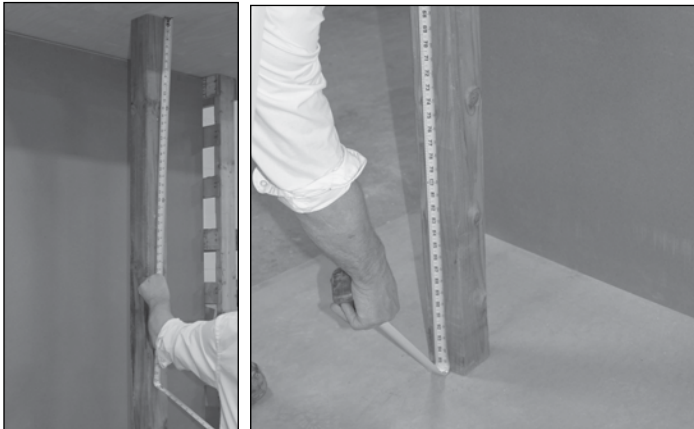

Next step is critical and must be executed with speed and precision. Read Cellular PVC Cement Manufacturer's instructions to determine dry time. Avoid potential spillage problems by placing panels on corrugated box and using 1" brush to apply PVC cement. And keep a rag and acetone nearby just in case.

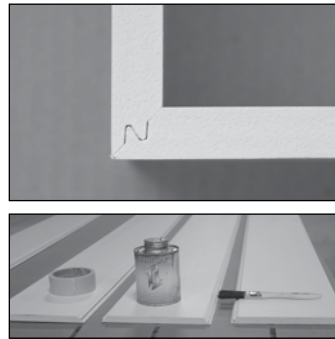

Please Note: this is how bottom male panels should look when joined.



2) Place 1 male panel face up between two female panels along each side. Make sure ends are aligned at top and bottom. Apply PVC Cement to grooves on each side of male panel. Then apply PVC Cement only on that side of each female panel that will be joined with male panel to form a U-shaped column.

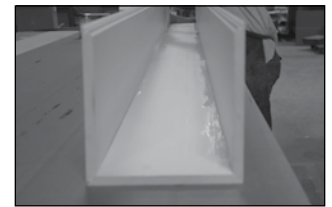
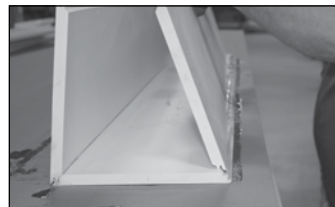

3) Once cemented panels are fitted into a U-shape, put remaining unglued panel on top and secure column with masking tape in several places to hold panels in place until cement is dry. Repeat to make U-Shaped cap and base. (see diagrams on back)



4) Make sure post is level and put squaring blocks into position around post. Measure distance from wall (or other reference point) on each side of the post (facing wall) to ensure squaring blocks are squared. Draw a line to mark position.



5) Place 3-sided U shaped column around squaring block (as marked) and mark exterior perimeter on floor and ceiling. Remove column and align U-shaped CAP along exterior panel line. Pencil mark interior side.

6) Place one set of squaring corners at base and fasten at pre-drilled hole. Repeat process for ceiling. Apply PVC Cement to remaining panel, ease into place and secure with masking tape. Fasten panels at top and bottom to squaring blocks. Then fasten cap and base to squaring blocks on all sides.

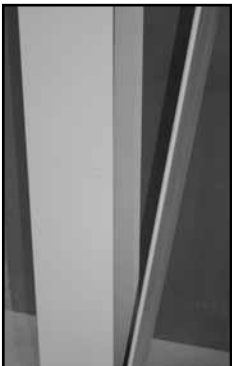

ADDITIONAL INFORMATION:

If you want to paint using custom colors in darker shades, the use of VinylSafe™ Technology from Sherwin Williams is recommended. Be careful in choosing a color because use of a paint with a Light Reflective Value (LVR) of 56 or lower can void the PVC manufacturer's warranty.

Cellular PVC should not be exposed to extreme heat in storage and installation should take place at temperatures at, or above, 50F° / 10-12C° otherwise materials can become brittle. To avoid fractures, pre-drill all holes where screws or nails will be used.

If installation is into concrete a hammer drill with variable speed, depth setting, and a grip is recommended. You will need to drill to a depth of 1 ½ " and use sleeve anchors / plugs; <http://www.wikihow.com/Drill-Into-Concrete> If using TAPCON® screws visit this site to determine correct drill bit and depth; <https://www.confast.com/articles/how-do-i-determine-the-size-of-bit-needed-for-my-tapcon-screw>.

For Additional information, please visit www.chemcrest.com